

NOT FOR CONSTRUCTION

Ramsay McCormack Building
City of Birmingham

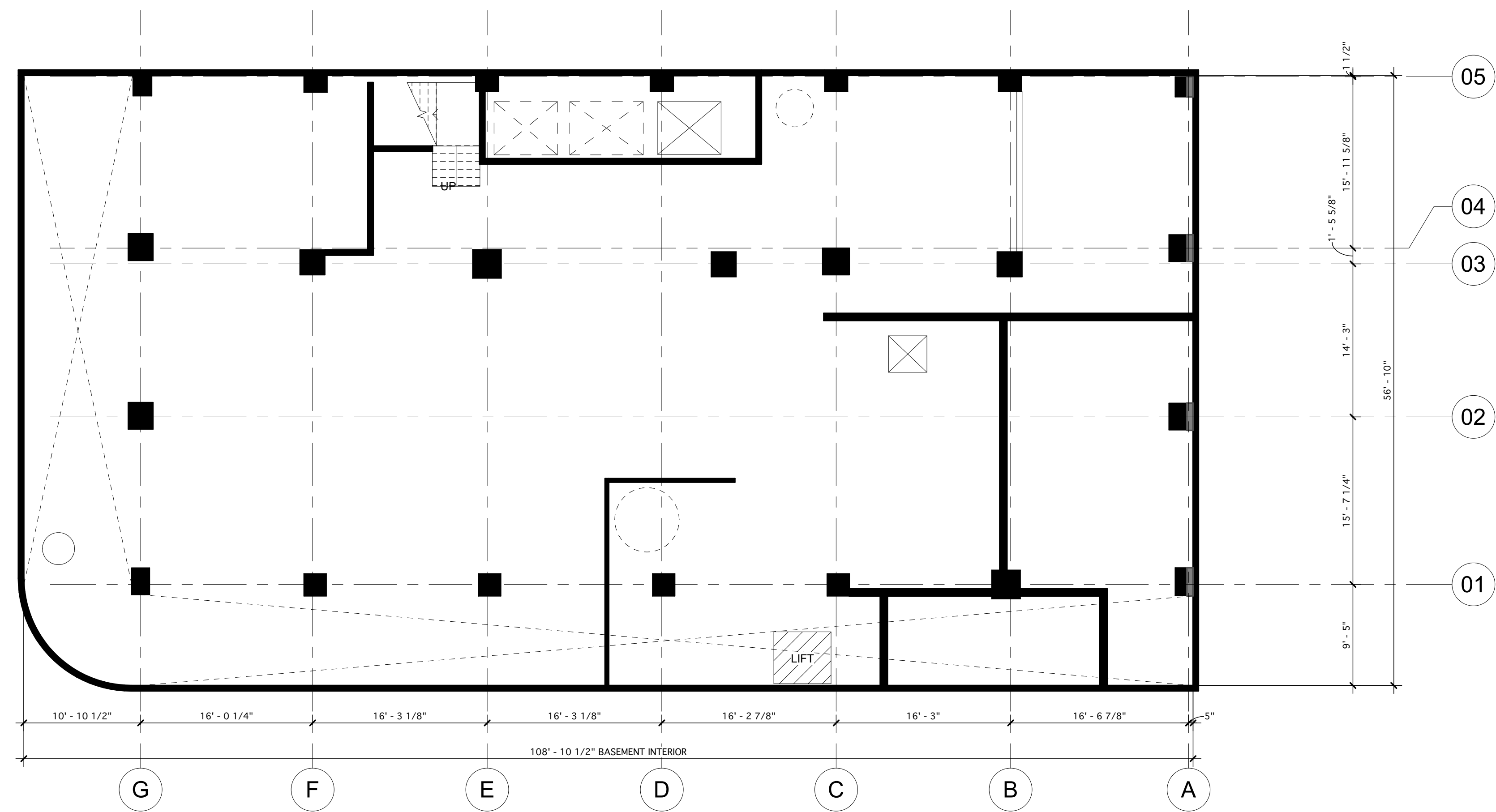

This drawing has been produced for the City of Birmingham. It was prepared for a purpose agreed with the client and will have a commensurate degree of accuracy. It is not a record "as built". ArchitectureWorks accepts no liability whatsoever if this drawing is used by any other person or for any other purpose.

ArchitectureWorks makes no representation as to the compatibility of these files with your hardware or your software. Any use or reuse by you or by others will be at your sole risk and without liability or legal exposure to ArchitectureWorks, LLP. You agree to make no claim and hereby waive, to the fullest extent permitted by law, any claim or cause of action of any nature against ArchitectureWorks, LLP, its officers, directors, employees, agents or subconsultants which may arise out of or in connection with your use of the electronic files.

Furthermore, you shall, to the fullest extent permitted by law, indemnify and hold harmless ArchitectureWorks, LLP from all claims, damages, losses and expenses, including attorney's fees arising out of or resulting from your use of these electronic files.

These electronic files are not contract documents. ArchitectureWorks, LLP makes no representation regarding the accuracy or completeness of the electronic files you receive. You are responsible for determining if any conflict exists. By your use of the electronic files, you are not relieved of your responsibility including and without limitation, the need to check, confirm and coordinate all dimensions and details, take field measurements, and verify field conditions.

Because of the potential that the information presented on the electronic files can be modified, unintentionally or otherwise, ArchitectureWorks, LLP reserves the right to remove all indicia of its ownership and/or involvement for each electronic display.

Under no circumstances shall delivery of the electronic files for use by you be deemed a sale by ArchitectureWorks, LLP, and ArchitectureWorks, LLP makes no warranties, either expressed or implied, of merchantability and fitness for any particular purpose. In no event shall ArchitectureWorks, LLP be liable for any loss of profit or any consequential damages.

PROJECT NORTH

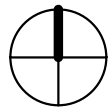

TRUE NORTH

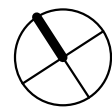

BASEMENT LEVEL EXISTING FLOOR PLAN

01

FLOOR PLAN - BASEMENT LEVEL

SHEET NO.

A102

NOT FOR CONSTRUCTION

Ramsay McCormack Building
City of Birmingham

[illegible]

	JOB
--	-----

PROJECT STATUS	
----------------	--

DATE _____

SET

SHEET NAME

**FLOOR PLAN -
1ST LEVEL**

SHEET NO.

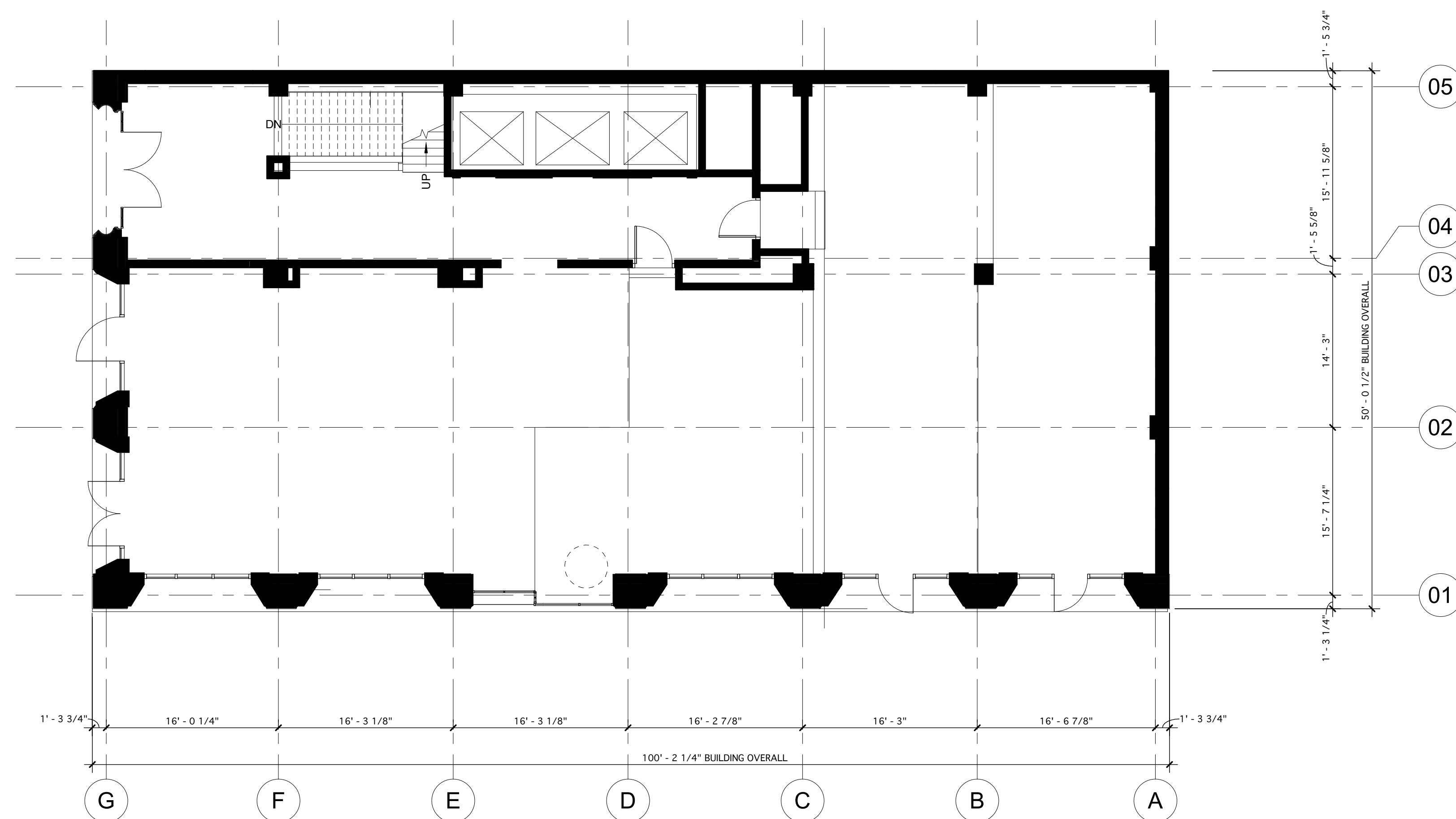

This drawing has been produced for the City of Birmingham. It was prepared for a purpose agreed with the client and will have a commensurate degree of accuracy. It is not a record "as built". ArchitectureWorks accepts no liability whatsoever if this drawing is used by any other person or for any other purpose.

ArchitectureWorks makes no representation as to the compatibility of these files with your hardware or your software. Any use or reuse by you or by others will be at your sole risk and without liability or legal exposure to ArchitectureWorks, LLP. You agree to make no claim and hereby waive, to the fullest extent permitted by law, any claim or cause of action of any nature against ArchitectureWorks, LLP, its officers, directors, employees, agents or subconsultants which may arise out of or in connection with your use of the electronic files.

Furthermore, you shall, to the fullest extent permitted by law, indemnify and hold harmless ArchitectureWorks, LLP from all claims, damages, losses and expenses, including attorney's fees arising out of or resulting from your use of these electronic files.

These electronic files are not contract documents. ArchitectureWorks, LLP makes no representation regarding the accuracy or completeness of the electronic files you receive. You are responsible for determining if any conflict exists. By your use of the electronic files, you are not relieved of your responsibility including and without limitation, the need to check, confirm and coordinate all dimensions and details, take field measurements, and verify field conditions.

Because of the potential that the information presented on the electronic files can be modified, unintentionally or otherwise, ArchitectureWorks, LLP reserves the right to remove all indicia of its ownership and/or involvement for each electronic display.

Under no circumstances shall delivery of the electronic files for use by you be deemed a sale by ArchitectureWorks, LLP, and ArchitectureWorks, LLP makes no warranties, either expressed or implied, of merchantability and fitness for any particular purpose. In no event shall ArchitectureWorks, LLP be liable for any loss of profit or any consequential damages.



FIRST LEVEL
EXISTING FLOOR PLAN

01
1/8" = 1'

SHEET NO.

A103

NOT FOR CONSTRUCTION

Ramsay McCormack Building
City of Birmingham

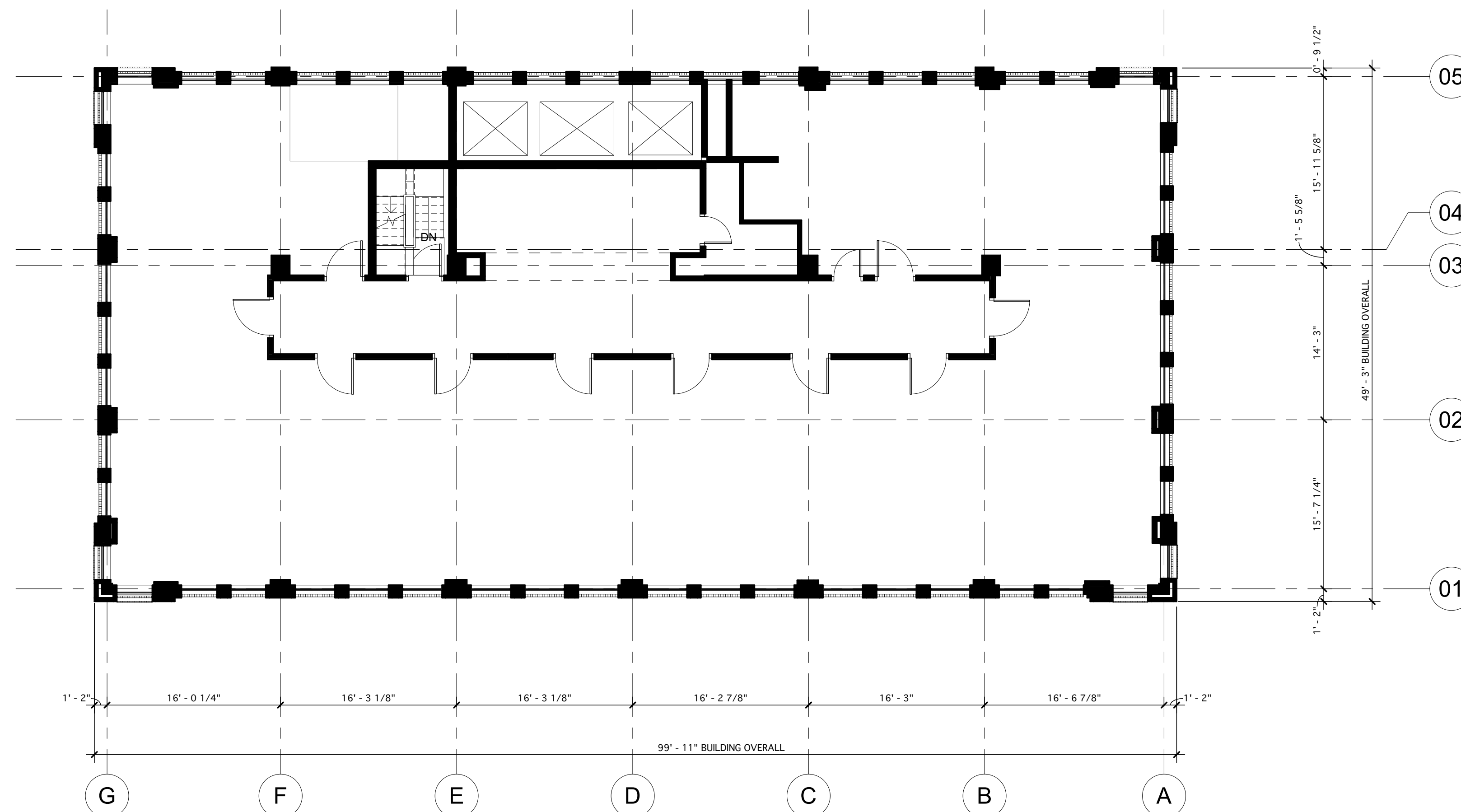

PROJECT NORTH

TRUE NORTH

A circular compass rose with a thick black line pointing towards the top-left, labeled 'TRUE NORTH'. The circle is divided into four quadrants by two thin diagonal lines.

TH TYPICAL UPPER LEVEL
EXISTING FLOOR PLAN

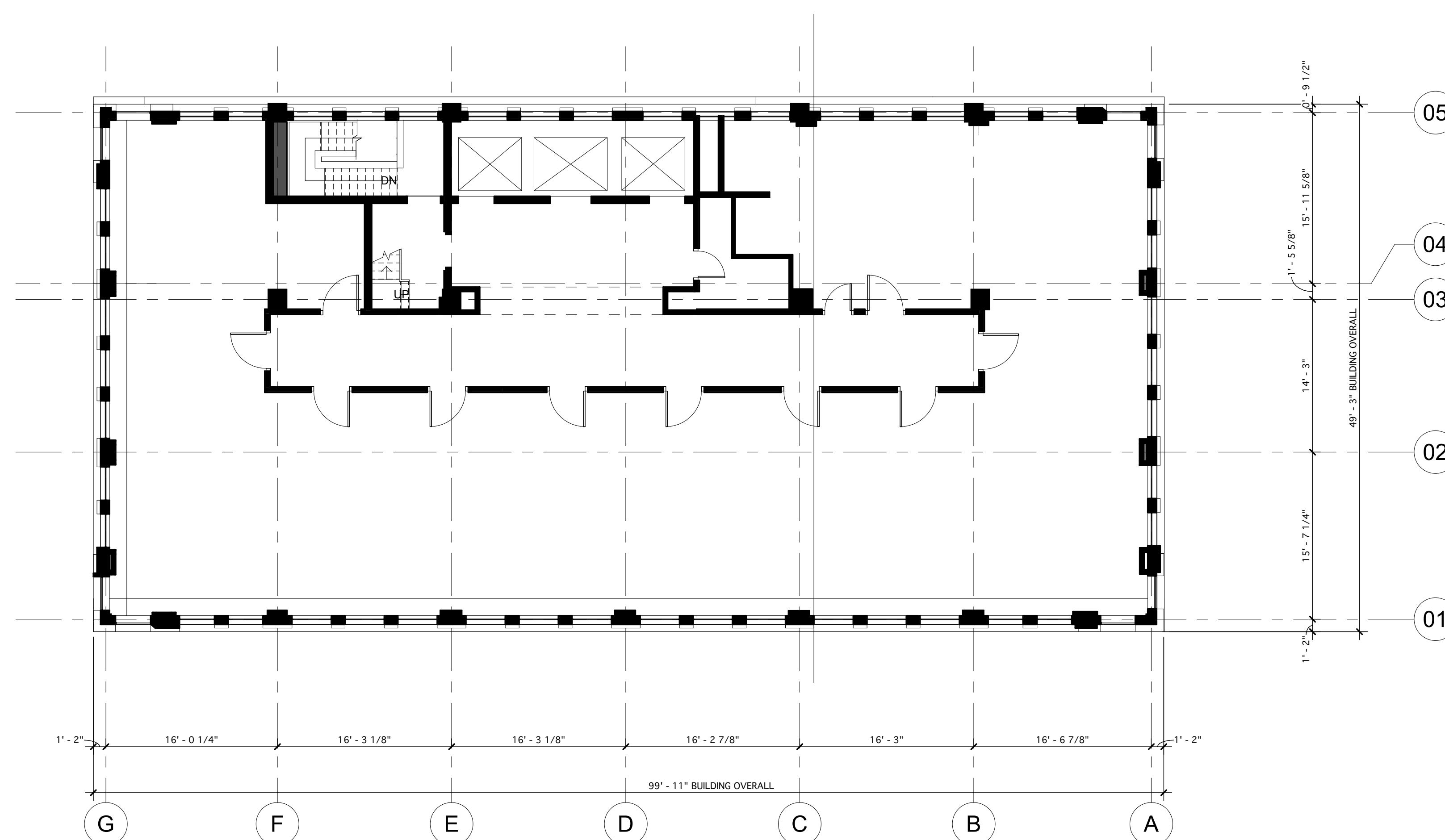
02
1/8" = 1'-0"

This drawing has been produced for the City of Birmingham. It was prepared for a purpose agreed with the client and will have a commensurate degree of accuracy. It is not a record "as built". ArchitectureWorks accepts no liability whatsoever if this drawing is used by any other person or for any other purpose.

ArchitectureWorks makes no representation as to the compatibility of these files with your hardware or your software. Any use or reuse by you or by others will be at your sole risk and without liability or legal exposure to ArchitectureWorks, LLP. You agree to make no claim and hereby waive, to the fullest extent permitted by law, any claim or cause of action of any nature against ArchitectureWorks, LLP, its officers, directors, employees, agents or subconsultants which may arise out of or in connection with your use of the electronic files.

Furthermore, you shall, to the fullest extent permitted by law, indemnify and hold harmless ArchitectureWorks, LLP from all claims, damages, losses and expenses, including attorney's fees arising out of or resulting from your use of these electronic files.

These electronic files are not contract documents. ArchitectureWorks, LLP makes no representation regarding the accuracy or completeness of the electronic files you receive. You are responsible for determining if any conflict exists. By your use of the electronic files, you are not relieved of your responsibility including and without limitation, the need to check, confirm and coordinate all dimensions and details, take field measurements, and verify field conditions.

Because of the potential that the information presented on the electronic files can be modified, unintentionally or otherwise, ArchitectureWorks, LLP reserves the right to remove all indicia of its ownership and/or involvement for each electronic display.

Under no circumstances shall delivery of the electronic files for use by you be deemed a sale by ArchitectureWorks, LLP, and ArchitectureWorks, LLP makes no warranties, either expressed or implied, of merchantability and fitness for any particular purpose. In no event shall ArchitectureWorks, LLP be liable for any loss of profit or any consequential damages.

PROJECT NORTH



TRUE NORTH



SECOND LEVEL EXISTING FLOOR PLAN

01
1/8" = 1'-0"[illegible]

NOT FOR CONSTRUCTION

Ramsay McCormack Building
City of Birmingham

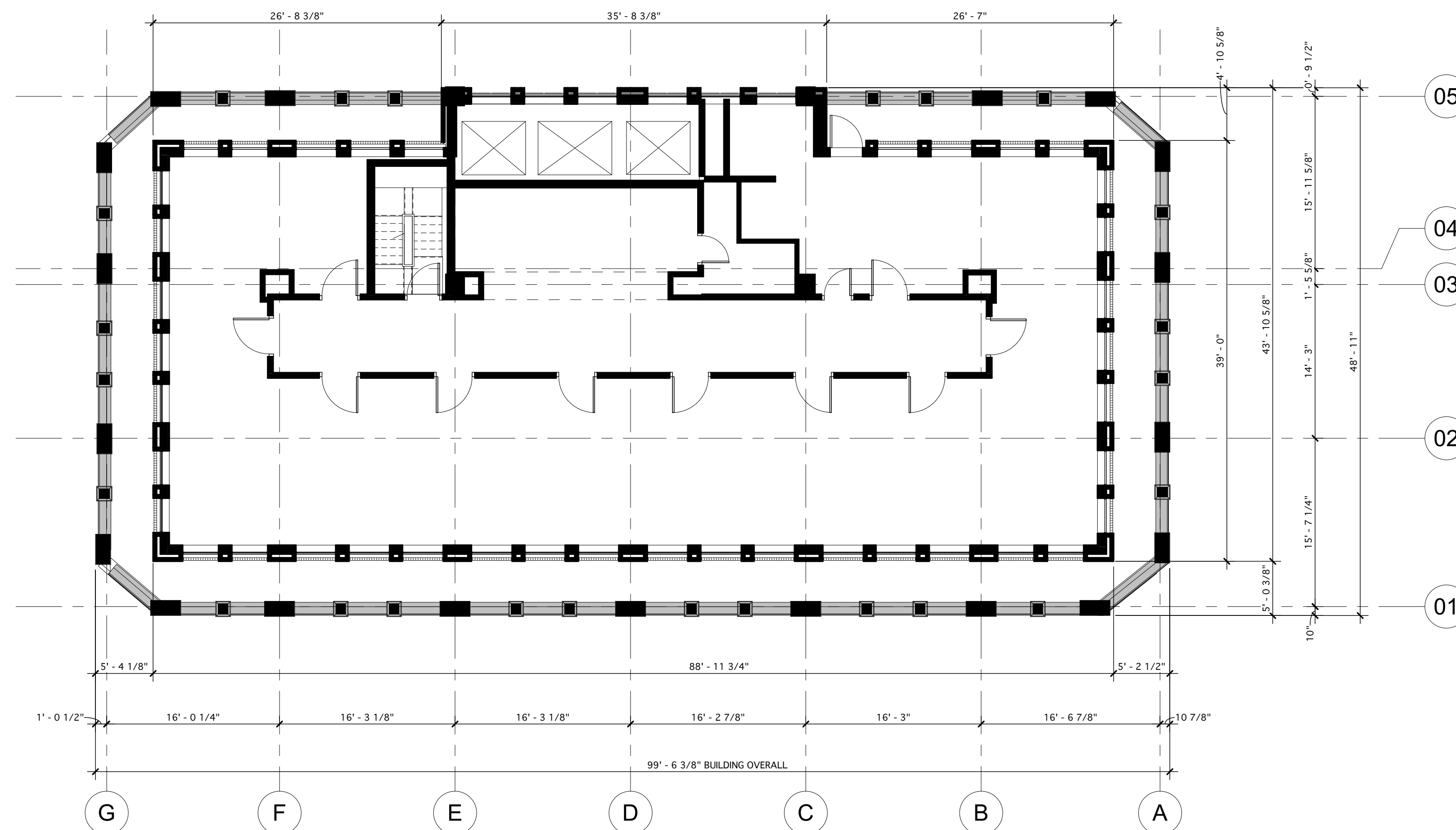

PROJECT NORTH



TRUE NORTH

A circular compass rose with four lines extending from the center to the edges. One line is thicker than the others and points towards the top-left corner of the diagram.

**TENTH LEVEL
EXISTING FLOOR PLAN**

02
1/8" = 1'-0"

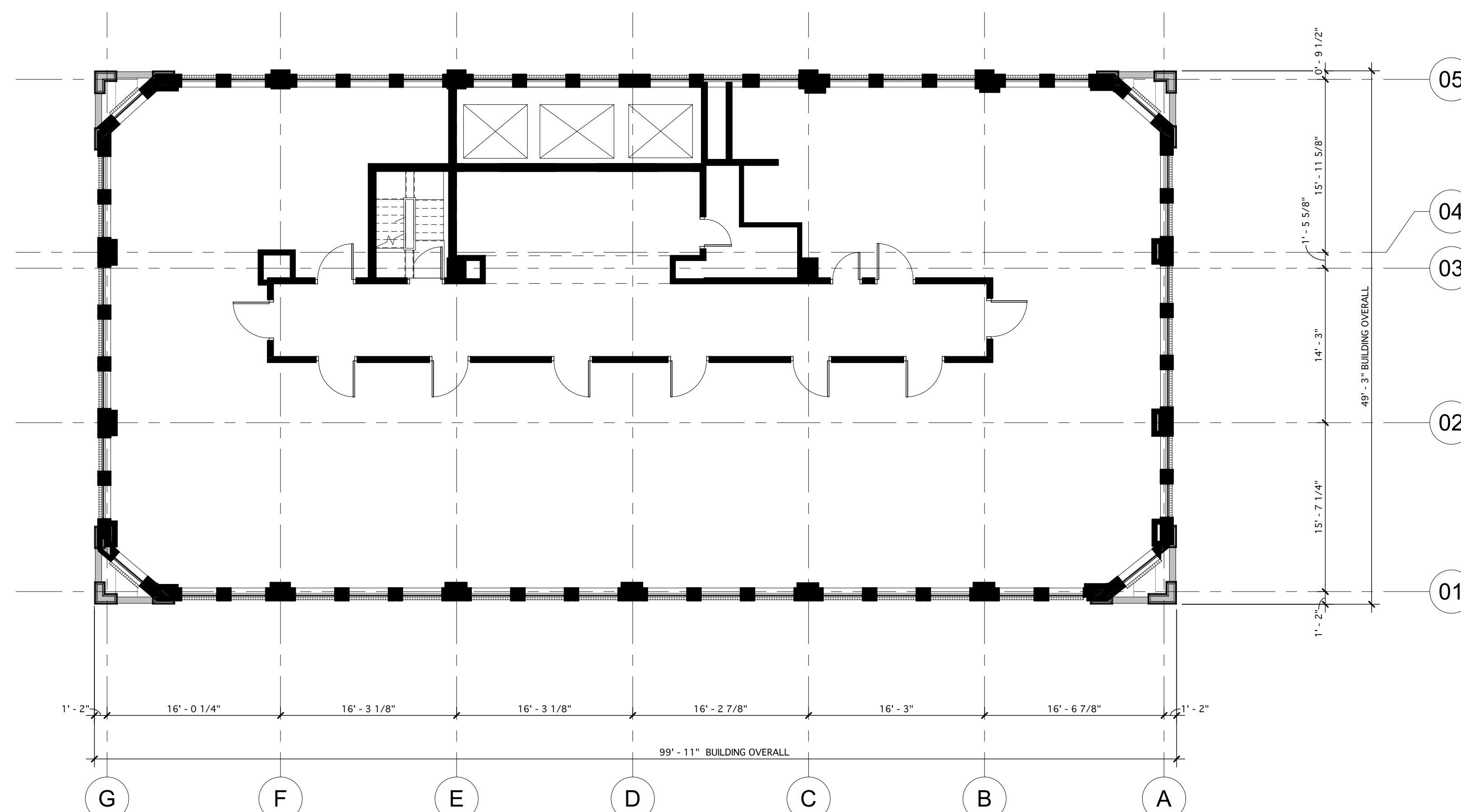

PROJECT NORTH



TRUE NORTH

**NINTH LEVEL
EXISTING FLOOR PLAN**

01
1/8" = 1'-0"

FLOOR PLANS -
9TH-10TH LEVELS

	SHEET NO.
--	-----------

A105

NOT FOR CONSTRUCTION

Ramsay McCormack Building
City of Birmingham

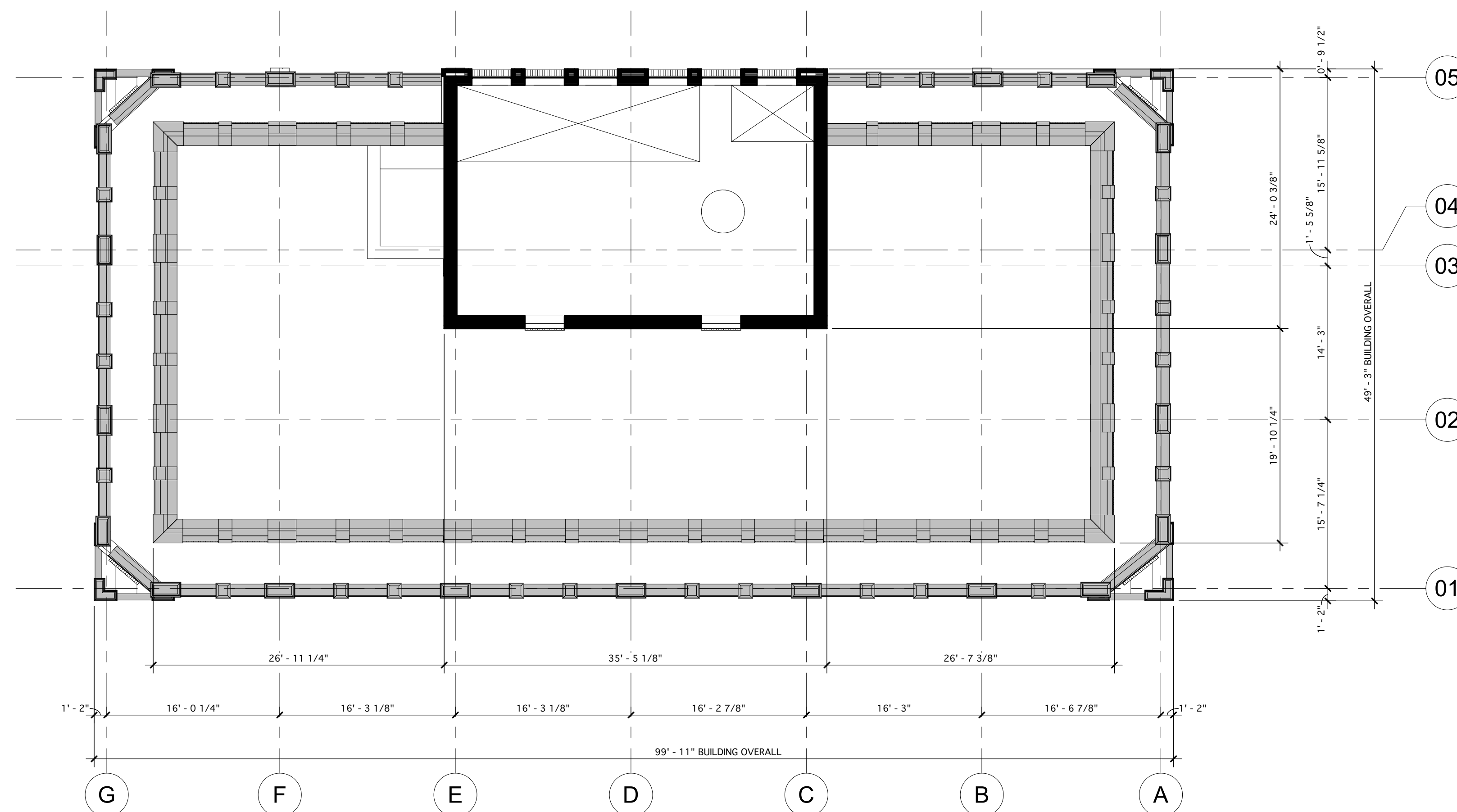

PROJECT NO. 

TRUE NORTH

**TWELFTH FLOOR
EXISTING FLOOR PLAN**

02
1/8" = 1'-0"

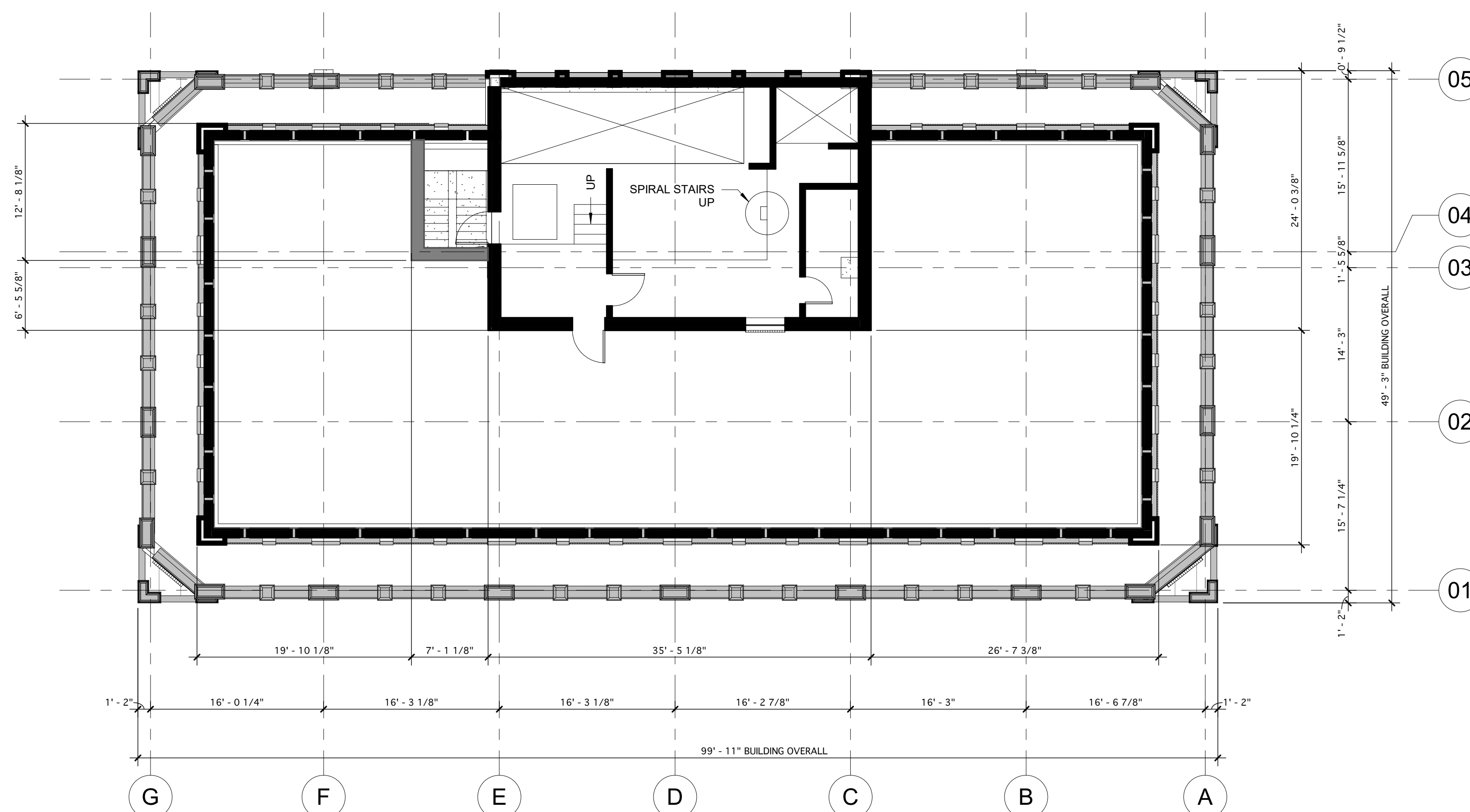

This drawing has been produced for the City of Birmingham. It was prepared for a purpose agreed with the client and will have a commensurate degree of accuracy. It is not a record "as built". ArchitectureWorks accepts no liability whatsoever if this drawing is used by any other person or for any other purpose.

ArchitectureWorks makes no representation as to the compatibility of these files with your hardware or your software. Any use or reuse by you or by others will be at your sole risk and without liability or legal exposure to ArchitectureWorks, LLP. You agree to make no claim and hereby waive, to the fullest extent permitted by law, any claim or cause of action of any nature against ArchitectureWorks, LLP, its officers, directors, employees, agents or subconsultants which may arise out of or in connection with your use of the electronic files.

Furthermore, you shall, to the fullest extent permitted by law, indemnify and hold harmless ArchitectureWorks, LLP from all claims, damages, losses and expenses, including attorney's fees arising out of or resulting from your use of these electronic files.

These electronic files are not contract documents. ArchitectureWorks, LLP makes no representation regarding the accuracy or completeness of the electronic files you receive. You are responsible for determining if any conflict exists. By your use of the electronic files, you are not relieved of your responsibility including and without limitation, the need to check, confirm and coordinate all dimensions and details, take field measurements, and verify field conditions.

Because of the potential that the information presented on the electronic files can be modified, unintentionally or otherwise, ArchitectureWorks, LLP reserves the right to remove all indicia of its ownership and/or involvement for each electronic display.

Under no circumstances shall delivery of the electronic files for use by you be deemed a sale by ArchitectureWorks, LLP, and ArchitectureWorks, LLP makes no warranties, either expressed or implied, of merchantability and fitness for any particular purpose. In no event shall ArchitectureWorks, LLP be liable for any loss of profit or any consequential damages.

PROJECT NO. 

TRUE NORTH

ELEVENTH FLOOR

EXISTING FLOOR PLAN

01
1/8" = 1'-4"

[illegible]